



Linnum

Slot drainage channels for tiled showers

A wide range of designs adapted to each installation requirements



Enjoy designs
adapted to each situation

Linum

The linear drainage allow stylish designs as it enables easier installation of built made shower slopes.

A wide range of solutions in 6 different lengths, 2 widths, versions with or without integrated traps, all of them thought to solve any situation.



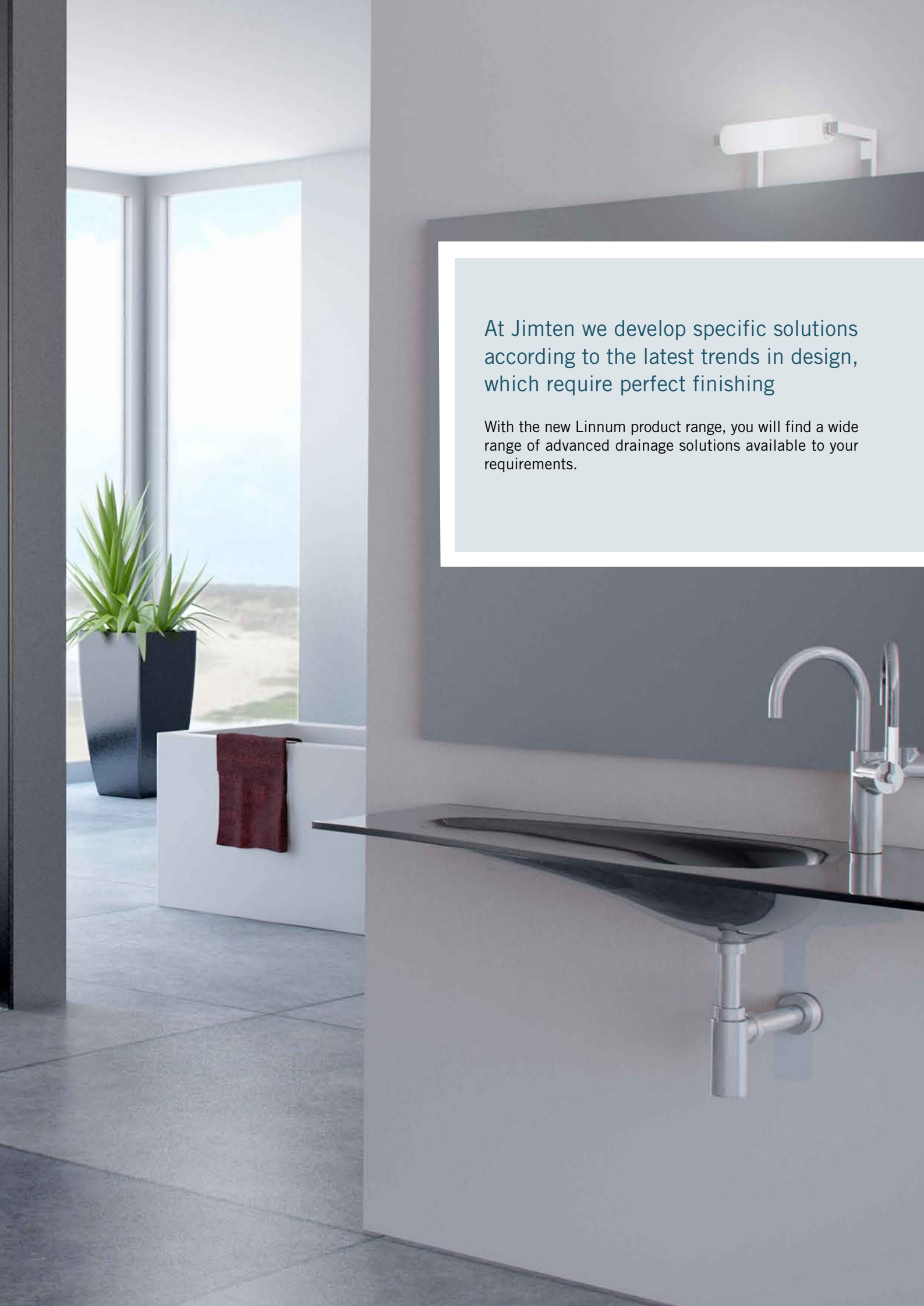

At Jimten we develop specific solutions according to the latest trends in design, which require perfect finishing

With the new Linum product range, you will find a wide range of advanced drainage solutions available to your requirements.

Choose your model

You may choose from a wide range of options in grid designs, lengths and connection versions. Choose the version which best suits your installation.



Models

5 grid designs

50 mm width

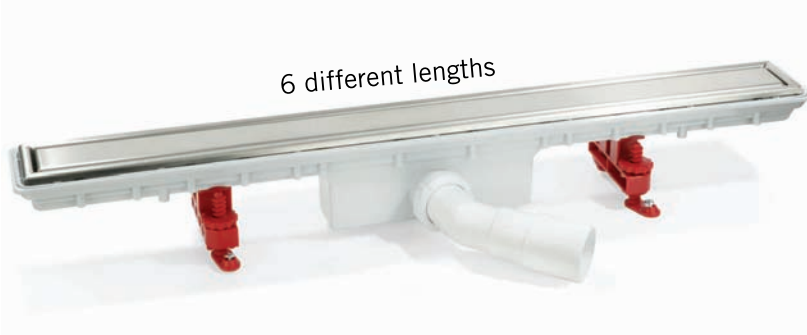
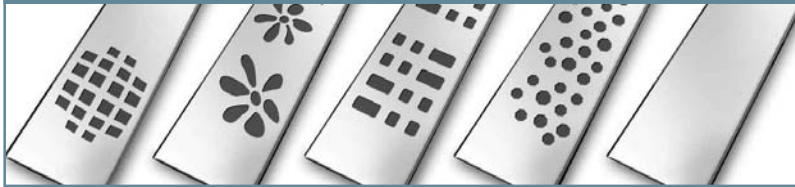

2 outlet versions:

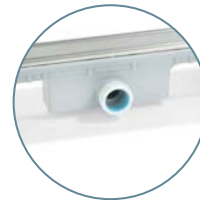

Female horizontal outlet in 40 mm



45° orientable male elbow 40/50 mm

5 grid designs

70 mm width

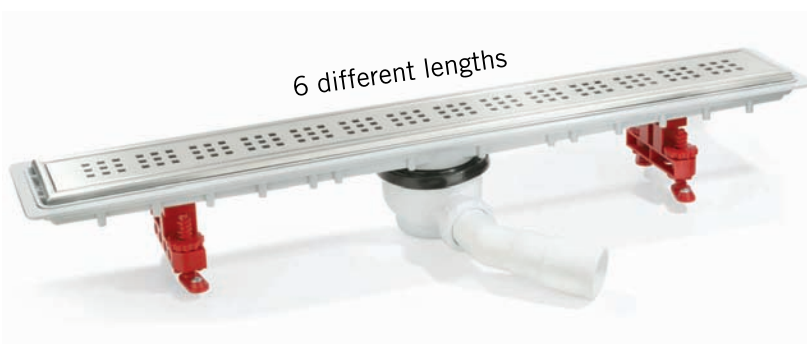

2 outlet versions:



Female horizontal outlet in 40 mm



45° orientable male elbow 40/50 mm



A thousand possible options

The Linum **SOFT** grid design is reversible which allow the personalization of the shower finishing.

Due to its reversible **SOFT** grid design, getting a finishing aligned with the bathroom tile, marble or other material design, can be obtained easily.

Its reversible grid system allows to obtain an smooth top finish which can be filled-in with the same material than the rest of the installation using a unique component.

The **SOFT** grid design is available in all Linum models.

Turn **180°** the **SOFT** grid design to obtain a fill-in frame using the same finishing than the rest of your installation.



SOFT grid design is supplied with distance holder pieces necessary to allow the flow of water to the drain.

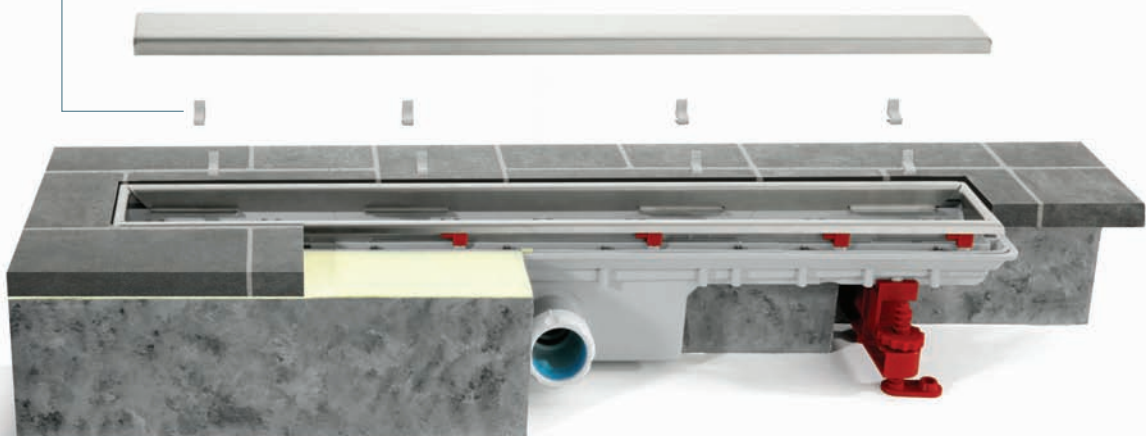

Linum 50 offers compact dimensions in six lengths

With the **Linum 50** range, formed by a channel body with integrated trap (which can optionally be removed) and a reduced lateral width which allow a close to wall installation, you can get flow rates up to 0.9 l/s (according to EN274), in addition, the outlet can rotate to any position.

Linum 50





Linnum 50



The exclusive water proofing membrane fixation technology, the supporting channel feet which can be attached to the floor, the different height regulation system whether the grid -adaptable to different tile thicknesses -or channel body- which can be levelled depending to floor cementing height, achieve an easy to install set, perfect finishing and reliable operation.



Product features Linum 50

Check all the technical characteristics of this product, which will allow you to solve a wide range installation situations in a simple way.

Stainless steel grid,
2 designs in stamping and
3 laser cut available in 6
different lengths.

■ Stainless steel grid
supplied separately

Protection cover to
be used during tiling
process

Stainless steel frame,
adjustable in height

Detachable interior PP injection
moulded trap with register cover for
inspection (Optional installation)

Unique clamping
system to securely attach
a water tightening fabric
onto the channel body

Dual positioning height regulations
pins, the grid and frame can absorb
from 6 until 16 mm tiling thickness

ABS injection moulded
body, with inner slope
for a better water flow.

Orientable waste outlet with o-ring with
nut & joint for 40 mm female
connections or PP 45° elbow for male
40/50 mm connections

Supporting feet, with height regulation,
it allows a secure fixation of the channel
to the floor while installing the channel
(with the supplied screws)

Complies with the EN274 standar



Linum 50

Complete channel with grid

S-751

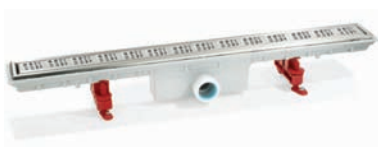

size øOutlet	length					
	350 mm	550 mm	650 mm	750 mm	850 mm	950 mm
40 female	13503	13505	13506	13507	13508	13509

Channels with **Elegance** grid design in 50 mm width and different lengths.



size øOutlet	length					
	350 mm	550 mm	650 mm	750 mm	850 mm	950 mm
40/50 male	13513	13515	13516	13517	13518	13519

Channels with **Elegance** grid design in 50 mm width and different lengths.

S-759



size øOutlet	length					
	350 mm	550 mm	650 mm	750 mm	850 mm	950 mm
40 female	13523	13525	13526	13527	13528	13529

Channels with **Soft** grid design in 50 mm width and different lengths.



size øOutlet	length					
	350 mm	550 mm	650 mm	750 mm	850 mm	950 mm
40/50 male	13543	13545	13546	13547	13548	13549

Channels with **Soft** grid design in 50 mm width and different lengths.

Wide range of grids

Solutions according to the different trends of design. We can choose from 5 different grid designs. Made in stainless steel laser or stamping cut.



Grids

Linum 50



Mod. Soft

Each grid has been manufactured in AISI 304 stainless steel, choose a design and a length from all the product range. **Spring, Square** and **Soft** designs are laser cut. **Elegance** and **Bubble** are stamping cut.

Grids are sold separately, they are not included in standard packaging.



Mod. Elegance

		length					
	model	350 mm	550 mm	650 mm	750 mm	850 mm	950 mm
S-752	Soft	13535	13555	13565	13575	13585	13595
S-753	Elegance	13536	13556	13566	13576	13586	13596
S-754	Square	13537	13557	13567	13577	13587	13597
S-755	Spring	13538	13558	13568	13578	13588	13598
S-756	Bubble	13539	13559	13569	13579	13589	13599

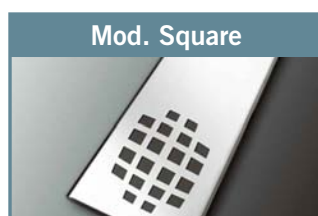

Mod. Square



Mod. Spring



Mod. Bubble





Linum 50

Slot drainage channels

Channel bodies are available as a complete set, in 6 different lengths. They include the following components: channel body ABS injection moulded with integrated trap, supporting feet adjustable in height, pins, fixation elements for watertight fabrics and internal detachable trap bell.

As an option, 2 outlet versions are available, you can choose from a female for smooth pipes connexion with tightening nut & joint in 40 mm or a 45° elbow for orientable PP male outlet in Ø40/50 mm.

S-750



Female horizontal outlet in 40 mm

size outlet	length					
	350 mm	550 mm	650 mm	750 mm	850 mm	950 mm
40 female	13530	13550	13560	13570	13580	13590

Channels in 50 mm width and different lengths.



45° orientable male elbow 40/50 mm

size outlet	length					
	350 mm	550 mm	650 mm	750 mm	850 mm	950 mm
40/50 male	13531	13551	13561	13571	13581	13591

Channels in 50 mm width and orientable outlet.

Dimensions (mm)

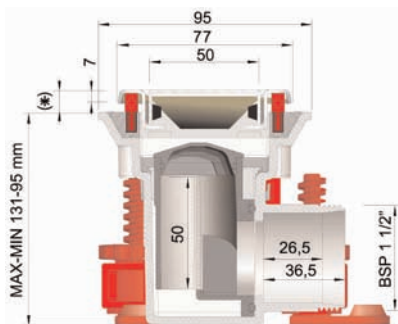

Complements



A-150

Size	Ref.
1,5x0,6 m	22390

A-145

Size	Ref.
2x1,5 m	22303

Water proofing membrane

You can complement a good product selection with a perfect water tightening by selecting a geotextile membrane, water tight so as to get a fast and secure installation.

Linum 70 offers
the best characteristics
in six lengths

With the **Linum 70** range, formed by a channel body with orientable waste outlet and accessible trap, you can get a flow rate up to 0.8 l/s (according to EN274). In addition a 360° rotation is available so the waste outlet can be oriented to the desired position.

Linum 70





Linum 70

The exclusive water proofing membrane fixation technology, the supporting channel feet which can be attached to the floor, the different height regulation system, the grid -adaptable to different tile thicknesses -or channel body- which can be levelled depending to floor cementing height, achieve an easy to install set, perfect finishing and reliable operation.



Product features

Linum 70

Check all the technical characteristics of this product, which will allow you to solve a wide range installation situations in a simple way.

Stainless steel grid,
2 designs in stamping
and 3 laser cut available
in 6 different lengths.

■ Stainless steel grid
supplied separately

Stainless steel frame,
adjustable in height

Protection cover to be used
during tiling process

Detachable interior PP injection
moulded trap with register cover for
inspection (Optional installation)

Unique clamping
system to securely attach
a water tightening fabric
onto the channel body

Dual positioning height regulations
pins, the grid and frame can absorb
from 6 until 16 mm tiling thickness

ABS injection
moulded body, with
inner slope for a better
water flow.

Orientable waste outlet with o-ring with
nut & joint for 40 mm female
connections or PP 45° elbow for male
40/50 mm connections

Supporting feet, with height regulation,
it allows a secure fixation of the channel
to the floor while installing the channel
(with the supplied screws)

Complies with the EN274 standard

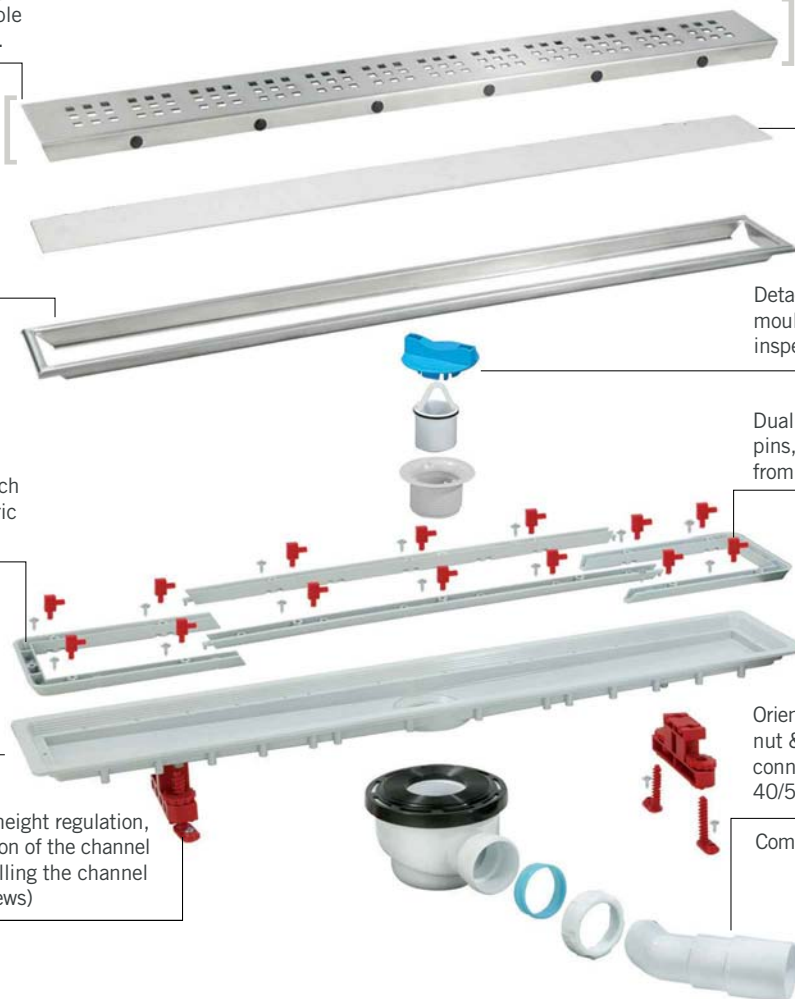



Linum 70

Slot drainage channel complete with grid

S-771



	length					
size outlet	350 mm	550 mm	650 mm	750 mm	850 mm	950 mm
40 female	13703	13705	13706	13707	13708	13709

Channels with **Classic** grid model, 70 mm width, different lengths.



	length					
size outlet	350 mm	550 mm	650 mm	750 mm	850 mm	950 mm
40/50 male	13713	13715	13716	13717	13718	13719

Channels with **Classic** grid model, 70 mm width, different lengths with orientable outlet.

S-779

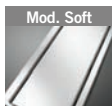

	length					
size outlet	350 mm	550 mm	650 mm	750 mm	850 mm	950 mm
40 female	13723	13725	13726	13727	13728	13729

Channels with **Soft** grid model, 70 mm width, different lengths.



	length					
size outlet	350 mm	550 mm	650 mm	750 mm	850 mm	950 mm
40/50 male	13743	13745	13746	13747	13748	13749

Channels with **Soft** grid model, 70 mm width, different lengths with orientable outlet.

Wide range of grids

Solutions according to the different trends of design. We can choose from 5 different grid designs. Made in stainless steel laser or stamping cut.



Grids

Linum 70

Mod. Soft



Each grid has been made in AISI 304 stainless steel. Choose one design and length from all the available grid lengths. **Garden, Waves, Soft** and **Sequence** models are laser cut manufactured. **Classic** model is produced by stamping cut.

Grids are sold separately, they are not included in standard packaging.

Mod. Classic



		length					
	model	350 mm	550 mm	650 mm	750 mm	850 mm	950 mm
S-772	Soft	13735	13755	13765	13775	13785	13795
S-773	Classic	13736	13756	13766	13776	13786	13796
S-774	Garden	13737	13757	13767	13777	13787	13797
S-775	Waves	13738	13758	13768	13778	13788	13798
S-776	Sequence	13739	13759	13769	13779	13789	13799

Mod. Garden



Mod. Waves



Mod. Sequence





Linum 70

Slot drainage channels

The channel bodies are available as a complete set, in 6 different lengths, they include the following: ABS injection moulded body, supporting feet height adjustable, screws, pins and water tightening fabric fixation elements.

As an option, two outlet types are available. You can choose from a female nut & joint connection for smooth pipes in Ø40 mm or a 45° orientable elbow, PP male outlet Ø40/50 mm.

S-770



Female horizontal outlet in 40 mm

size øoutlet	length					
	350 mm	550 mm	650 mm	750 mm	850 mm	950 mm
40 female	13730	13750	13760	13770	13780	13790

Channels in 70 mm width and different lengths.



45° orientable male elbow 40/50 mm

size øoutlet	length					
	350 mm	550 mm	650 mm	750 mm	850 mm	950 mm
40/50 male	13731	13751	13761	13771	13781	13791

Channels in 70 mm width and orientable outlet.

Dimensions (mm)

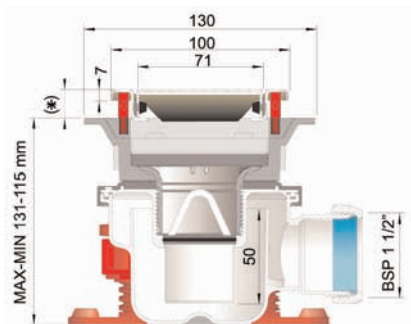

Complements



A-150

Size	Ref.
1,5x0,6 m	22390

A-145

Size	Ref.
2x1,5 m	22303

Water tightening geotextile fabric.

You can complement a good product selection with a perfect water tightening by selecting a geotextile membrane, water tight, so as to get a fast and secure installation.

Installation instructions

Get a perfect installation. The different height regulation elements, channel body fixation, outlet which can be oriented, water tightening fixation elements and protections during the installation process, which will enable you to get a perfect finishing.

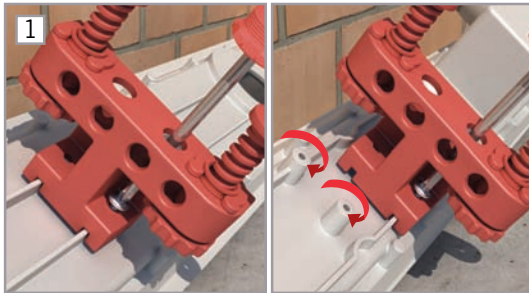

1 Fix the supports to the channel body. Choose the holes depending on the outlet position.



2 Remove or attach the internal trap when necessary.



3 Present the set onto the installation site. Mark, drill and screw it to the floor.



4 Choose the desired height.

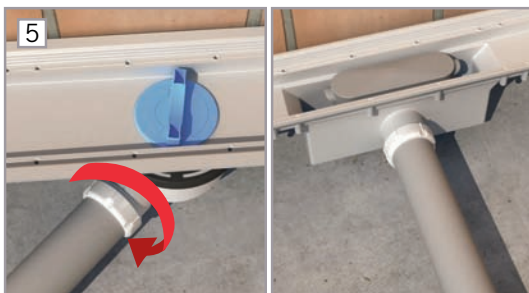

5 Attach the pipe to the outlet by gluing the pipe onto the ABS channel body or by tightening the nut and joint.



6 Fill in the base of the channel and the other part of the installation.

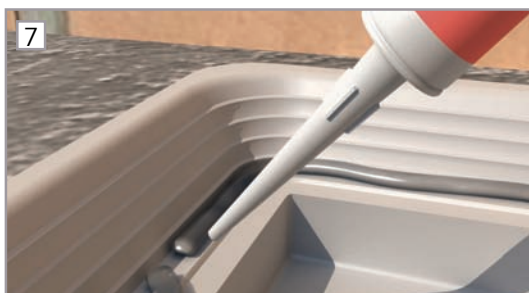

7 Apply sealant along the channel body perimeter.

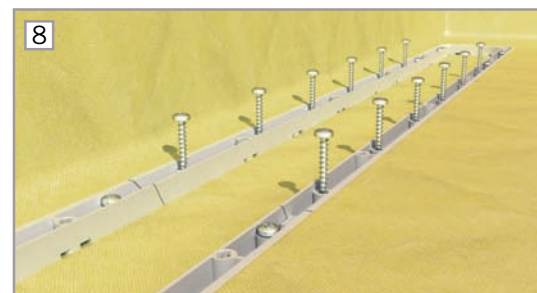

8 Place the water tightening fabric and fix it to the channel body with the supplied screws.



Linnum

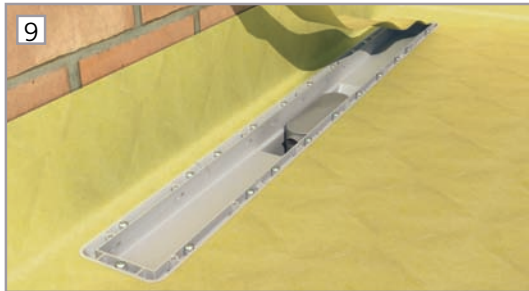

9 Cut and remove the unused part of the water tightening fabric.

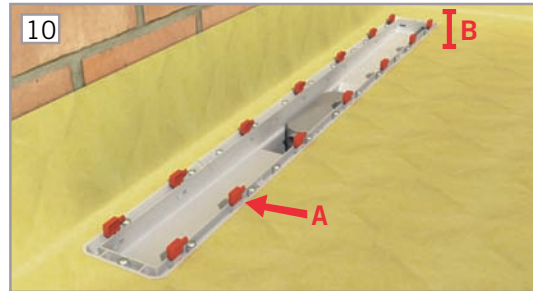

10 Choose the pin A and its position according to the tile thickness B and the selected adhesive.



11 Place the frame onto the pins (or the channel body).



12 Protect the frame during the tiling process using the supplied cover.



13 Fill the floor with a 1-2% slope towards the channel.
Tile the walls and the floor.



14 Remove protection cover.

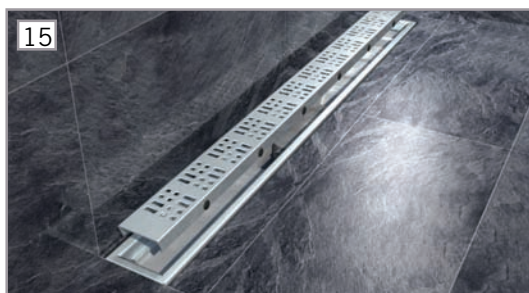

15 Install the chosen grid design.



16 Get a perfect installation done.



Linum

Lineal slot channel system for masonry built shower trays



©JIMTEN 3M
45747 02-11

jimten, SA
CTRA. DE OCAÑA, 125 C.P. 03114
✉ 5285 C.P. 03080
☎ + 34.965.10.90.44
Fax. + 34.965.11.50.82
ALICANTE (ESPAÑA)
www.jimten.com
Empresa registrada según norma



an *OAliaxis* company